

MEUBLES S.D'EAU - WC

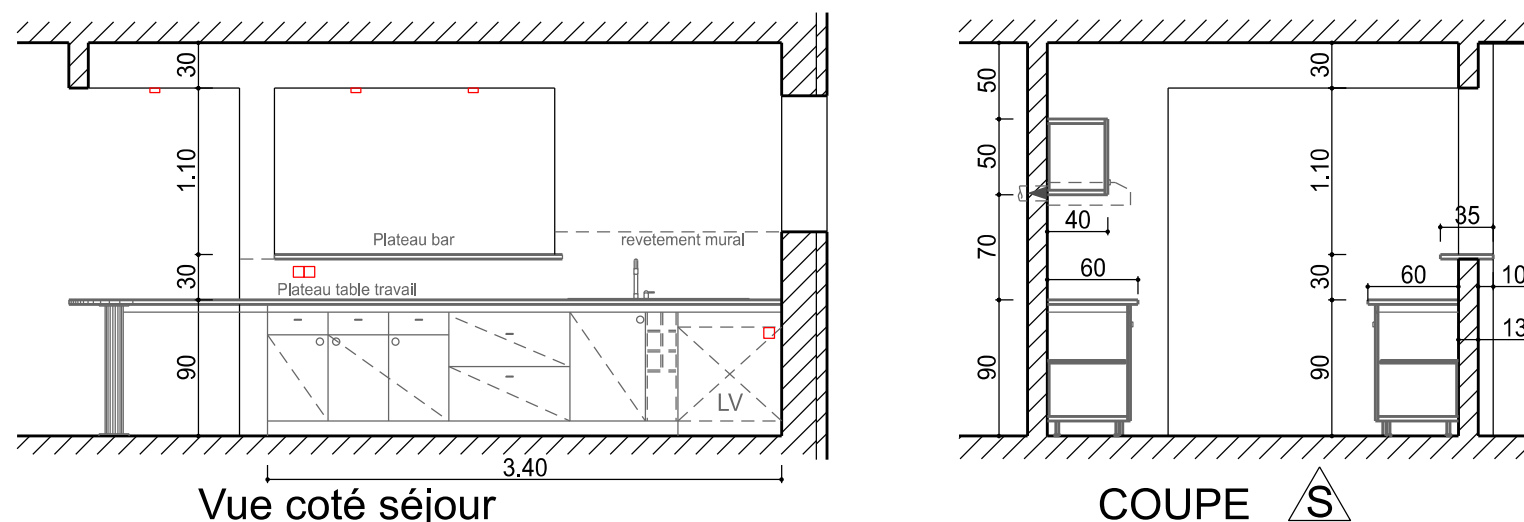

MEUBLES CUISINE

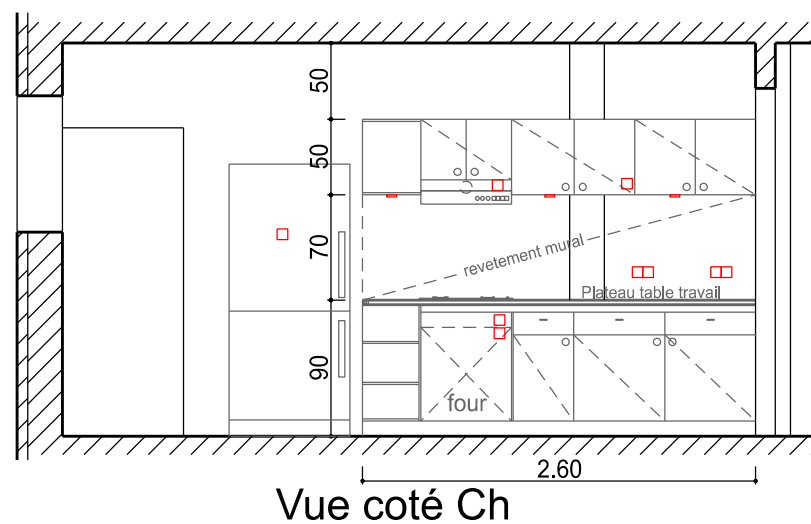

AMENAGEMENT PLACARDS et DRESSING

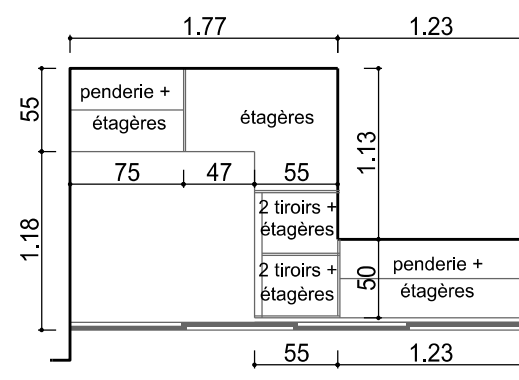

4 portes coulissantes

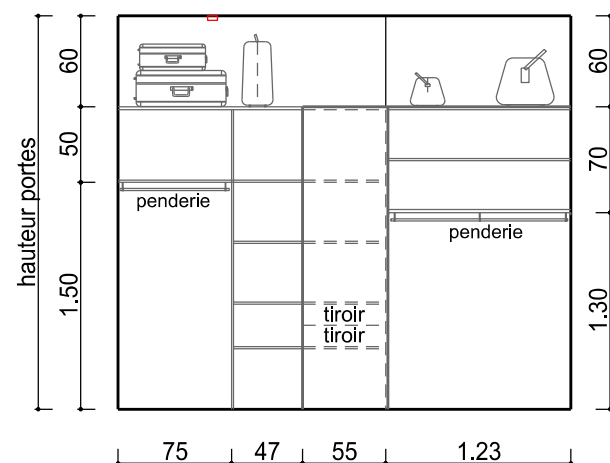

Ch3

2 portes coulissantes

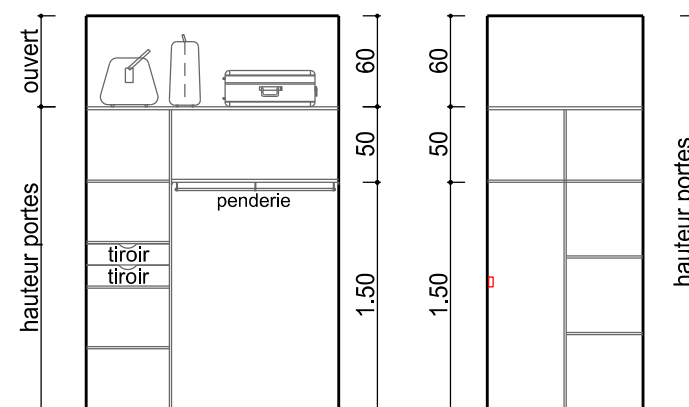

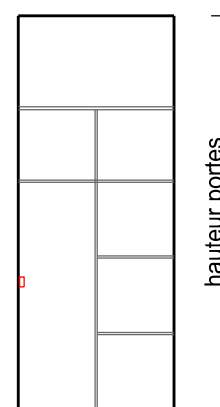

Ch1 et Ch2

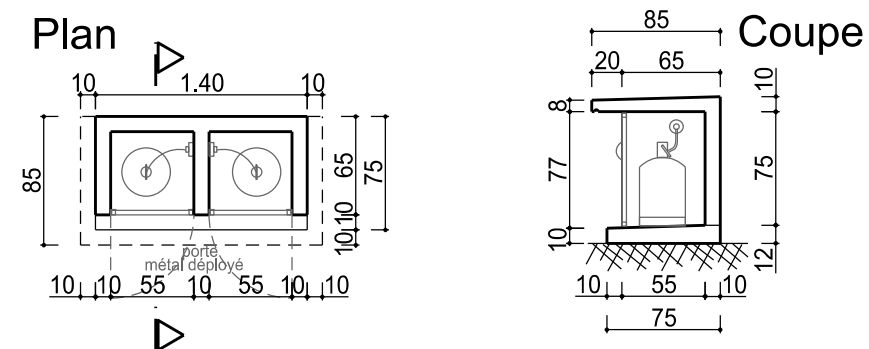

Dgt2

ABRI GAZ



<div></div> <div>DIRECTION D'INFRASTRUCTURE de la DEFENSE de NOUMÉA</div>	<div>Chargé d'affaires : TSEF BIRRIÉ C Tel: 687-292952</div>	<div>Nouméa Pointe Chaleix logements base navale Chaleix Réhabilitation du bâtiment logement 035</div>	<div>SGA</div>	<div>SID</div>	<div> Liberté • Égalité • Fraternité RÉPUBLIQUE FRANÇAISE</div> <div>MINISTÈRE DES ARMÉES</div>	
	<div>Architecte : IMI. SAUVÉ Tel: 687-292992</div>		<div>COSI N° 453986 Nom du fichier: 988818-045H_I_COMP_DCE</div>			<div>Projet 24 024</div>
	<div>Dessiné par : OET. t. PIERREZ</div>	<div>DCE</div>	<div>Date Aout 2024</div>	<div>N°Ordre 11 / 11</div>		<div>Indice A</div>
	<div>Directeur de la DID Nouméa IC1MI LANCIEN</div>	<div>DETAILS ETAT FUTUR</div>				
	<div>Echelle : 1 / 50</div>					